

Parts List				Parts List			
ITEM	QTY	PART NUMBER	DESCRIPTION	ITEM	QTY	PART NUMBER	DESCRIPTION
1	8	013-0059-00	M12x1.75I Nylon-Insert Locknut	19	1	026-0326-00	Top Discharge Blower Deck Mount ZT/Maverick
2	4	013-2050-00	1/4-20 NYL INSERT FLANGE LOCKNUT ZINC	21	1	030-0050-00	5/16-24 X 1/4 SOCKET SET SCREW (CUP PT) PLAIN
3	2	013-8049-00	5/16-18 NYLON INSERT FLANGE LOCKNUT ZINC	22	10	030-7041-00	1/4-20 X 1/2 HEX WASHER SLOT (F) TCS ZINC
4	5	013-8050-00	1/2-13 NYLON INSERT FLANGE LOCKNUT ZINC	23	1	033-4900-00	4x1 v- pulley
5	4	013-9001-00	1/4-20 HEX SERRATED FLANGE NUT HARD/ZINC	24	1	033-5034-00	4 3/4" Motor Pulley
6	2	018-0085-00	7/16-20 X 1 HEX CAP SCREW (GR.5) ZINC	25	1	033-6001-00	4 3/4 Idler Pulley - ABFI-76
7	8	018-0083-00	M12x1.75 x30mm	26	1	034-0090-00	3" spring with closed loop ends
8	4	018-2026-00	1/4-20 X 1/2 BUTTON SOCKET CAP SCREW 18-8 STAINLESS STEEL	27	2	037-1000-00	F206 Bearing
9	1	018-2080-00	1/2-13 X 1-1/4 HEX CAP SCREW (GR.5) ZINC	28	1	039-4950-00	8" blower chute
10	2	018-3001-00	5/8 X 5/8 SOCKET SHOULDER BOLT ZINC YELLOW	29	1	040-6070-00	Blower latch pin
11	2	018-4007-00	1/4-20 X 1 HEX CAP SCREW (GR.5) ZINC	30	1	042-6030-00	1/4 X 1 SQ MACHINERY KEY 1018 STL PLN
13	2	018-5049-00	1/2-13 X 2 HEX CAP SCREW (GR.5) ZINC	31	1	044-2004-00	Bow Pin
14	2	019-6020-00	1/2 BELLEVILLE WASHER (1-5/8 OD X .140 THK) ZINC	33	1	088-1961-00	ZT Blower Top Discharge Weldment
15	2	019-8053-00	7/16 SPLIT LOCKWASHER (GR.8) ZINC YELLOW	34	1	026-0323-00	outer bearing cover
16	1	019-8054-00	.505 ID X 1.000 OD X .125 THICK FLAT WASHER NYLON	35	1	032-5055-00	.500 ID X .625 OD X .312 HGT X .750 FLNG DIA X .094 FLNG THK BUSHING BRONZE
17	2	025-7036-00	1/2 SOLID SHAFT COLLAR (W/1 SET SCREW) ZINC	36	1	026-0328-00	ZT Door bearing plate
18	1	026-0325-00	Blower spring arm Short	37	1	088-1949-00	ZT Top Discharge Blower fan weldment V2

Hardware bag #088-0033-00

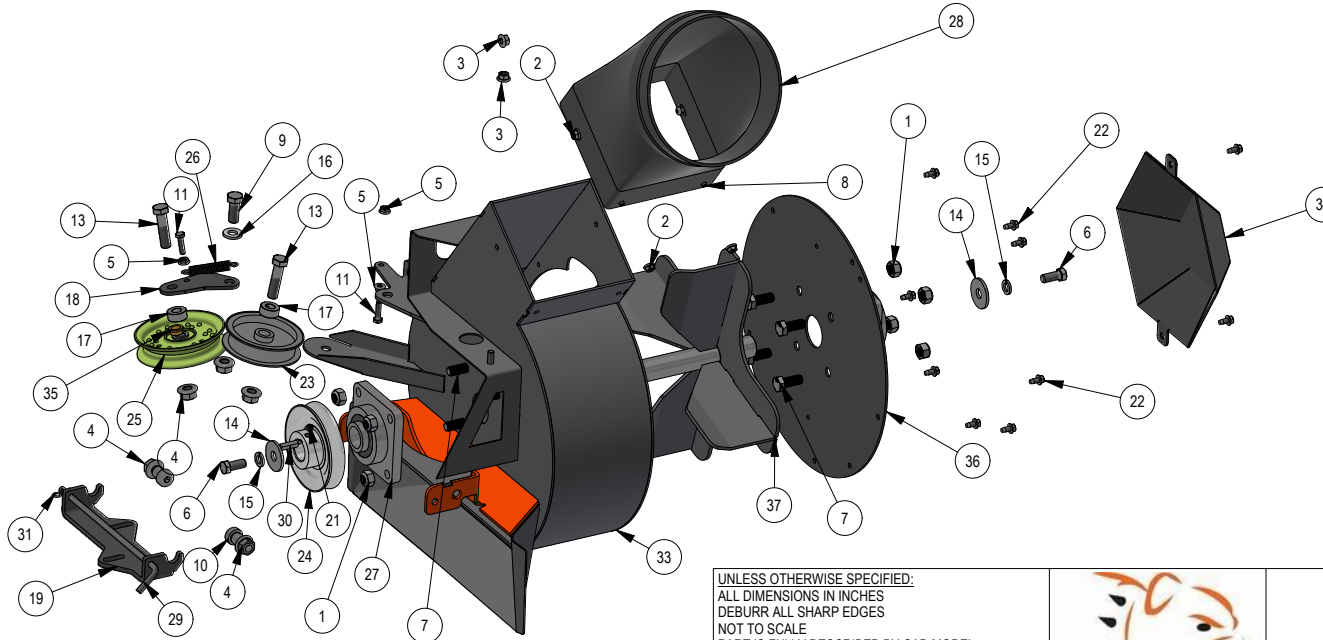

UNLESS OTHERWISE SPECIFIED:
 ALL DIMENSIONS IN INCHES
 DEBURR ALL SHARP EDGES
 NOT TO SCALE
 PART IS FULLY DESCRIBED BY CAD MODEL

TOLERANCES:
 XX = ± .01
 XXX = ± .005
 XXXX = ± .0005
 ANGULAR = ± 1°

Material:
 See Parts List
 Coating:



BAD BOY MOWERS
 Bad Boy Inc.
 102 Industrial Drive
 Batesville, Arkansas
 72501

Scale: NTS
Sheet Number 1 OF 1
Revision:
Part Number 088-1960-00
Description ZT/ Maverick Blower Top Discharge Assembly