



RECON ATTACHMENTS
MINI SKID STEER FRONT
ROTARY BRUSH CUTTER
OWNER'S OPERATOR SERVICE MANUAL

For additional information, please see us at
www.badboycountry.com



Owners/Operators Manual

Model Number _____

Serial Number _____

Serial Numbers 185600 and Greater
Date Created 05/07/26
Revised Date 05/07/26

Warranty Statement

1. WHAT THIS WARRANTY COVERS, AND FOR HOW LONG:

Bad Boy Mowers, LLC will, at its option, repair or replace without charge, any part covered by the warranty which is found to be defective in material and/or workmanship for one (1) year after the date of sale to the original retail purchaser **unless the product is used for rental purposes, in which case there is no warranty.**

At Bad Boy Mowers, LLC's request, customer will make the defective part available for inspection by Bad Boy Mowers, LLC and/or return the defective part to Bad Boy Mowers, LLC, with **transportation charges prepaid.**

2. WHAT THIS WARRANTY DOES NOT COVER:

- A. This warranty does not cover defects caused by depreciation or damage caused by normal wear, accidents, improper maintenance, improper use or abuse of the product, alterations, or failure to follow the instructions contained in the Owner's Manual for operation and maintenance.
- B. The customer shall pay any charges for making service calls and/or for transporting the implement to and from the place where the inspection and/or warranty work is performed. Bad Boy Mowers, LLC will not be responsible for the pickup and delivery of the implement for warranty purposes.
- C. Normal maintenance services or normal deterioration of exterior finish due to use or exposure.
- D. Replacement of services and items are subject to normal service replacement.

3. HOW TO OBTAIN SERVICE UNDER THIS WARRANTY:

- A. Warranty service can be arranged by contacting the dealer where you purchased the implement or by sending an email to warranty@badboycountry.com. Proof of the date of purchase may be required to verify warranty coverage. Warranty repairs must be completed by an authorized Bad Boy center.
- B. Warranty claims will not be reviewed or paid unless the warranty registration is received by Bad Boy Mowers, LLC within 30 days of the retail purchase date.
- C. Warranty claims requiring parts returned will be settled upon return of parts to Bad Boy for inspection.
- D. All warranty issues must be handled through an authorized service center or dealership.

4. **WARRANTY LIMITATION:**

A. **THERE IS NO OTHER EXPRESS WARRANTY. ANY WARRANTY THAT MAY BE IMPLIED FROM THIS PURCHASE, INCLUDING MERCHANTABILITY AND FITNESS FOR A PARTICULAR PURPOSE IS HEREBY LIMITED TO THE DURATION OF THIS WARRANTY AND TO THE EXTENT PERMITTED BY LAW. ANY AND ALL IMPLIED WARRANTIES ARE EXCLUDED.** Some states do not allow limitations on how long an implied warranty lasts, so the above limitations may not apply to you.

B. **BAD BOY MOWERS, LLC WILL NOT BE LIABLE FOR ANY INCIDENTAL, CONSEQUENTIAL, OR SPECIAL DAMAGES AND/OR EXPENSES IN CONNECTION WITH THE PURCHASE OR USE OF THE IMPLEMENT.** Some states do not allow the exclusion or limitation of incidental or consequential damages, so the above limitation(s) or exclusion(s) may not apply to you.

C. Only the warranty expressed in this limited warranty shall apply and no dealer, distributor, or individual is authorized to amend, modify, or extend this warranty in any way. Accordingly, additional statements such as dealer advertising or presentations, whether oral or written, do not constitute warranties by Bad Boy Mowers, LLC and should not be relied on.

D. This warranty extends only to implement operated under normal conditions and properly serviced and maintained. The warranty expressly does not cover (i) any defects, damage, or deterioration due to normal use, wear and tear, or exposure; (ii) normal maintenance services; (iii) damage or defects arising out of or relating to misuse, neglect, alteration, negligence, or accident; (v) repair or replacement arising from operation of or use of the implement which is not in accordance with operating instructions as specified in the Operator's Manual or other operational instructions provided by Bad Boy Mowers, LLC; (vi) repair or replacement arising as a result of any operation from implement that has been altered or modified so as to, indetermination of Bad Boy Mowers, LLC, adversely affect the operation, performance, or durability of the implement or that has altered, modified, or affected the implement so as to change the intended use of the product; (vii) repair or replacement necessitated by use of parts, accessories, or supplies, including gasoline, oil, or lubricants that are incompatible with the implement or other than as recommended in the Operator's Manual or other operational instructions provided by Bad Boy Mowers, LLC; (viii) repairs or

replacements resulting from parts or accessories which have adversely affected the operation, performance, or durability of the implement; or (ix) damage or defects due to or arising out of repair of implement by person or persons other than an authorized Bad Boy Mowers, LLC service dealer or the installation of parts other than genuine Bad Boy Mowers, LLC recommended parts. **As a condition of this warranty, customer shall have read the Operator's Manual and ensured the implement has been registered within 30 days of purchase.**

- E. This warranty gives you specific legal rights, and you may also have other rights, which vary from state to state.

**BAD BOY MOWERS, LLC
102 INDUSTRIAL DRIVE
BATESVILLE, AR 72501**

WWW.BADBOYCOUNTRY.COM

Technical Support:.....techsupport@badboycountry.com
Warranty:.....warranty@badboycountry.com
Parts:.....partsdept@badboycountry.com

Warranty Registration

Ensure selling dealership has registered the implement within 30 days of purchase to validate warranty. Please record the serial number, date of purchase, and dealership information for your records.

Serial # _____

Date of Purchase _____

Dealer Information _____

Features of Bad Boy V20 Compact Brush Cutters include:

- 3" diameter maximum cutting capacity.
- Hydraulic motor covering flow rates of 11-18 GPM.
- Standard dual hydraulic pressure relief valves with dynamic braking.
- 3800 psi maximum operating pressure.
- 1/2" x 4" single side, updraft blades.
- Standard large 3 blade circular flywheel for smooth operation.
- Standard spindle guard protects bearing adapter output shaft seal.
- Recommended for compact loaders with a lift capacity over 590 lbs.
- Standard motor guard protects motor and hydraulic components.

Compact Brush Cutter Specs

MODEL	CBC42	CBC48	CBC42-O	CBC48-O
Cut Width (Inches)	42.0	48.0	42.0	48.0
Overall Width (Inches)	47.0	53.0	47.0	53.0
Minimum Cut Height (Inches)	2.0			
Cutting Capacity Diameter (Inches)	3.0			
Recommended Flow Rate (GPM)	11 - 18			
Approximate Weight with Mini Universal Mount (Pounds)	620 ²	720 ^{2 3}	590 ²	690 ^{2 3}
Recommended Loader Capacity	Greater than 590 pounds			

²Bobcat mount adds 35 pounds to model weight, and ³ASV mount adds approximately 40 pounds.

Safety

- Always follow safety and operating information in this manual.
- Always follow all safety and operating instructions of compact loader.
- Never remove material deflectors or warning labels.
- Make sure all safety labels are in place, look in this manual for locations.
- Keep bystanders back 200 feet at all times. Do not operate near buildings, traffic, pets or livestock.
- Never allow riders on V20 Compact Brush Cutter, even when blades are not rotating.
- Before cutting an area, thoroughly check for obstructions such as pipes, fence posts, wire/cable, rocks, etc. Remove obstructions, if possible, flag any obstructions too large to move.
- Use extreme care when cutting close to fences, ditches, large obstacles, and on hillsides.
- Always relieve pressure before disconnecting hydraulic hoses.
- Clean any debris from attachment. Pay special attention to any debris in quick-tach area.

Compact Brush Cutter Labels

⚠ DANGER	
	
<p>FLYING OBJECT HAZARD</p> <ul style="list-style-type: none"> • Keep bystanders 200 feet away during operation. • Avoid or remove objects that could be thrown or damage blades. • Failure to follow these instructions could result in injury or death. 	<p>CUTTING HAZARD</p> <ul style="list-style-type: none"> • Keep hands and feet away from rotary cutter while in operation or with engine running. • Keep all covers in place. • See additional safety and operational instructions in Owner's Manual. • Follow all safety and operational instructions in Loader Operator's Manual. • Failure to follow these instructions could result in injury or death.
13612PP	

13612PP - DANGER HAZARD LABEL

⚠ DANGER
STAY CLEAR 200 FEET

7388PP - DANGER STAY CLEAR LABEL

⚠ WARNING
<ul style="list-style-type: none"> • NEVER use hands to check for oil leaks. • ALWAYS relieve pressure before disconnecting hoses. • ALWAYS disconnect hoses before performing any maintenance on rotary cutter. • Attachment must be securely latched to loader. • Before leaving operator's station, lower lift arms to stops, place cutter flat no the ground, disengage hydraulics, stop engine, engage parking brake and make sure all rotation has stopped. • Inspect blades before each use, replace damaged blades. Blades CAN NOT be straightened or welded. • Check for other loose or broken parts before operating, repair as needed. • Avoid stalling rotary cutter. Continued stalling will overheat hydraulic system. • ALWAYS follow loader safety and operating instructions. • Stay back 200 feet during operation. • See additional safety and operational instructions in Owner's Manual. • Read and understand all operating and safety instructions in Owner's Manual before operating. • Failure to follow these instructions could result in injury or death.
<div style="display: flex; align-items: center;">  <p>WARNING: This product can expose you to chemicals including Cadmium, which is known to the State of California to cause cancer and birth defects or other reproductive harm. For more information go to www.P65Warnings.ca.gov.</p> </div>
7386PP

7386PP – MAIN WARNING LABEL

⚠ WARNING
<ul style="list-style-type: none"> • Lift limit chain MUST be properly installed during operation of rotary cutter. • See Owner's Manual for lift limit chain installation instructions. • Failure to follow these instructions could result in injury or death.
7387PP

7387PP - LIFT LIMIT WARNING LABEL

Compact Brush Cutter Labels (cont.)



11628PP - CUTTER BLADE ROTATION LABEL

Initial Use

- Read and understand all warning information in this manual before operating this attachment.
- Check that quick-tach on frame fits onto compact loader properly. Pins must engage through plates at bottom of quick-tach.
- Slowly roll back attachment. Make sure there is no interference between attachment and compact loader.
- Make sure hoses do not pinch during roll back.
- Attach Lift Limit Chains. (See details in “Operation” section of this manual.)
- Flow rate **cannot** exceed maximum flow rate noted on the label on the surface of the cutter’s deck (18 GPM).
- Start the V20 Compact Brush Cutter at an idle, bring up to engine operating rpm, stop cutter (see “Operation” section of this manual) and check for oil leaks per instructions in “Maintenance” section of this manual.
- Never exceed the maximum attachment operating pressure of 3800 psi.

Operation

- Never operate V20 Compact Brush Cutter unless you have been properly trained.
- Make sure all safety labels are in place, look in this manual for locations.
- Lift Limit Chains must be installed for safe operation of V20 Compact Brush Cutter. Both chains need to be attached to the loader. For loaders with one front tie down, run both chains to the one tie down. If the loader has two front tie downs, run one chain to each. (See picture below.) Chain length should be adjusted so the rear of the deck (near the loader) should not be allowed to raise higher than 12" above the ground. Both chains need to be adjusted to the same length to prevent unnecessary twisting of loader arms. The V20 Compact Brush Cutter should NEVER be operated with the rear deck more than 12" above the ground. Doing so creates a great risk of damage to the loader as well as injury or death of the operator.



Correct installation of lift limit chain (Item #54) and lift limit retainer plate (Item #55).

- Check that all bolts are tight and that no parts are damaged. Make sure blades swing freely. Check blades for cracks or damage, replace as needed. Blades should always be replaced in sets. Never try to straighten or weld on blades.
- Never cut material larger than 3" diameter.

Operation (cont.)

- Engage hydraulics at an idle, then bring loader to desired engine operating rpm. The V20 Compact Brush Cutter should be stopped before slowing engine rpm. It is equipped with dynamic braking and an anti-cavitation valve. Throttling down the loader before disengaging the hydraulics has greater potential to damage the cutters hydraulic system than disengaging the hydraulics at operating rpm.
- If blade rotation does not match your preferred detent position, the couplers can be switched on the hoses.
- Do not operate on or drive across steep slopes.
- Stop and inspect entire unit for damage after striking any foreign objects. Replace or repair any damaged components before continuing.
- Before dismounting, lower lift arms to stops, place cutter flat on the ground, disengage hydraulics, stop engine, engage parking brake and make sure all rotation has stopped.
- Since the V20 Compact Brush Cutter can rotate in either direction, the operator must determine which direction the cutter is spinning. When looking top down on the deck, the V20 Compact Brush Cutter should spin in a counter clockwise direction, as shown on the Cutter Blade Rotation Label. If, during the initial use, the V20 Compact Brush Cutter does not seem to have power, cuts poorly or easily stalls, the cutter is likely rotating in the incorrect direction. Change the direction of the cutter by reversing the direction of flow after bringing the unit to a complete stop.

Cutting Recommendations

- Continuous rotation of the blades is required to prevent overheating. If the cutter stalls, disengage hydraulics and remove cutter from material before restarting.
- Engage hydraulics at an idle. When blades are rotating smoothly, bring loader to engine operating rpm. Do not engage cutter into material to be cut until blades are running smoothly at engine operating rpm.
- If blades are slowing or loader engine rpm is decreasing, reduce travel speed into material to be cut or take less than full width cuts to maintain blade speed.

Cutting Recommendations (cont.)

- For tall grass and heavy vegetation, raise the back of the cutter 2" - 3" off of the ground to better allow material to exit the cutter. Place the front skid shoes 1" - 2" off of the ground and drive into material. Never drive with the front of the cutter raised to a height where your view is obstructed. Never raise the unit to a height to expose yourself or others to the rotating blades. If you can see the blades, the unit is raised too high.
- When cutting large brush/small trees up to 3" diameter, keep the back of the cutter at or near ground level and roll the front of the cutter so it is 12" - 24" above the ground. Drive slowly into the material. The tilt cylinders of the loader can be used to bend over small trees. As the tree bends over, the blades will cut it off. The tree can be mulched by rotating the front of the cutter upward and driving over it moving forward. The tree can be further mulched by rolling the front of the cutter downward near ground level and backing up. Repeat as needed. The back of the cutter should be at or near ground level.

Blade Tip Speeds

Blade tip speeds at specified flow rates in gallons per minute (GPM).
Blade tip speeds listed in feet per minute.

MODEL	11 gpm Minimum	15 gpm	18 gpm Maximum
CBC42	6,980	9,520	11,430
CBC42-O	6,980	9,520	11,430
CBC48	7,980	10,880	13,070
CBC48-O	7,980	10,880	13,070

Maintenance

Procedure	Before Each Use	After Every 10 Hours	Every 50 Hours
Make sure all safety labels are in place, look in this manual for locations.	✓	✓	
Check oil level	✓	✓	
Check for loose, worn, or missing parts, repair or replace as needed.	✓	✓	
Check that all bolts are tight and that no parts are damaged.	✓	✓	
Make sure blades swing freely, check blades for cracks or damage and replace as needed.	✓	✓	
Remove any foreign debris such as string, wire, branches, etc. that may have wrapped around the flywheel.	✓	✓	
Inspect motor and bearing adapter, valves, hydraulic fittings, and hoses for leaks and damage, replace as needed.	✓	✓	
Thoroughly clean (power washing is recommended) both the topside and underside of the brush cutter deck. This will help identify any areas that may be damaged broken or worn, repair as necessary.			✓

- When checking the oil in the V20 Compact Brush Cutter bearing by removing plug on the side, just above the mount flange (It may be necessary to remove the motor guard). If needed, add oil through hole or remove plug on top of bearing adapter, near the motor. Reinstall plug(s). When empty, bearing adapter holds 12 ounces of oil. Oil to be SAE 80W-90 gear lubricant, API-GL-5 approved.
- When checking the bolts are tight pay special attention to the 6 bolts (Item #42) that hold the Flywheel Assembly (Item #34, 35, 36, 37) to the Bearing Adapter (Item #51). If any of the 6 bolts are loose, remove, apply Loctite and re-install and torque to proper value. See "Bolt Torque" section in this manual for proper torque values.
- Blades should always be replaced in sets. Never try to straighten or weld blades. Do not heat or pound on blades. Blades should be replaced if excessively nicked or worn. Bent blades need to be replaced immediately. Blade bolts and nuts MUST be replaced with the blades. Blades can be sharpened. Blades should be sharpened at the same time and same amount to maintain balance of the cutter. For best blade wear, do not sharpen blades to an edge, leave the blades 1/32" - 1/16" blunt.
- Make sure loader is shut off and hydraulic pressure is relieved before checking for leaks. Never use hands to check for high pressure hydraulic leaks.

Maintenance (cont.)

- The pressure relief valves require no maintenance. The valves are pre-set and require no adjustment. Changing settings may cause damage to the motor or change the rate the blades slow to a stop. Please call Bad Boy with any questions or problems regarding the pressure relief valves.
- If the V20 Compact Brush Cutter is still under warranty, contact your dealer before attempting any repairs. **Bearing adapters and motors that have been disassembled without prior approval will not be covered under warranty.** Motors and bearing adapters need to be intact for Bad Boy to get any warranty reimbursement from the component manufacturer. If the component manufacturer declines warranty due to tampering or misuse, Bad Boy reserves the right to void warranty as well.
- Contact your dealer for any required replacement parts.

Blade Replacement Procedure

- Make sure hydraulics are disconnected from machine and deck is properly supported as you will need access to the bottom of the deck. The V20 Compact Brush Cutter is heavy and steps need to be taken to make sure the deck is stable and secure before making any repairs.
- Loosen 3/8" bolts (Item #28) securing blade bolt access cover (Item #29), and swing cover out of the way. Spin flywheel until blade bolt appears in access hole.
- Loosen and remove the 1" nut (Item #49) retaining the blade. The square neck on the bolt (Item #44) will prevent the bolt from spinning. When the nut is removed, the blade (Item #45) should drop freely from the flywheel.
- Reinstall new blade and hardware (this step may require additional help) and torque to the specified torque (see "Drive and Blade Assembly" section). **Note: There is a special washer (Item #48) that needs to be installed between the spacer (Item #47) and nut (Item # 49). Additionally, the square holed spacer (Item #46) should be flush with the flywheel and oriented with the blade bolt (Item #44)**
- Repeat above steps for the remaining blades.
- Reinstall blade bolt access cover and tighten retaining hardware.

Flywheel Removal and Installation

- Make sure hydraulics are disconnected from machine and deck is properly supported as you will need access to the bottom of the deck. The V20 Compact Brush Cutter is heavy and steps need to be taken to make sure the deck is stable and secure before making any repairs. The flywheel weighs approximately 125 lb. and care needs to be taken when handling.
- From the underside of the deck, remove 4 of the 6 – 3/4" bolts (Item #4) that hold the flywheel (Item #20) to the bearing adapter (Item #2); the 2 bolts left should be opposite each other. **Do Not** remove all 6 bolts at this time.
- Support the flywheel using blocking and remove the last 2 bolts that hold the flywheel to the bearing adapter. The flywheel should fall free of the bearing adapter. The use of a floor jack is recommended to finish removal of the flywheel.
- To reinstall, the flywheel should be positioned under the bearing adapter so the bolt holes are aligned. Using a jack, lift the flywheel until it comes in contact with the bearing adapter. Block up flywheel and remove jack. Install at least 2 bolts opposite each other to hold the flywheel in position. Remove blocking and install the remaining 4 bolts. Tighten and torque (see "Bolt Torque Chart"). It is recommended to use Loctite on the 6 bolts (Item #4) that hold the flywheel to the bearing adapter.

Bolt Torque Chart

SIZE	GRADE 5		GRADE 8		SHCS*	
	COARSE	FINE	COARSE	FINE	COARSE	FINE
1/4"	6	7	9	10	10	12
5/16"	13	15	18	20	22	24
3/8"	23	26	33	37	38	43
7/16"	37	41	52	58	61	68
1/2"	57	64	80	90	93	105
9/16"	82	91	115	128	134	150
5/8"	113	128	159	180	179	202
3/4"	200	223	282	315	317	354

*SHCS—Socket Head Cap Screw

Values lubricated conditions are in ft.-lb. and are recommended unless otherwise noted.

Compact Brush Cutter Labels Parts List

ITEM	PART NO.	QTY	DESCRIPTION
1	7386PP	2	MAIN WARNING LABEL
2	7387PP	1	LIFT LIMIT WARNING LABEL
3	7388PP	2	DANGER STAY CLEAR LABEL
4	13612PP	2	DANGER HAZARD LABEL
A	5	7489PP	18 GPM MAX LABEL
B	6	13157PP	42 WIDTH LABEL
B	7	10259PP	48 WIDTH LABEL
8	18333PP	1	BAD BOY SERIAL TAG
9	11628PP	1	CUTTER BLADE ROTATION LABEL

A – Item is not shown.

B – Only one is needed depending on the configuration.

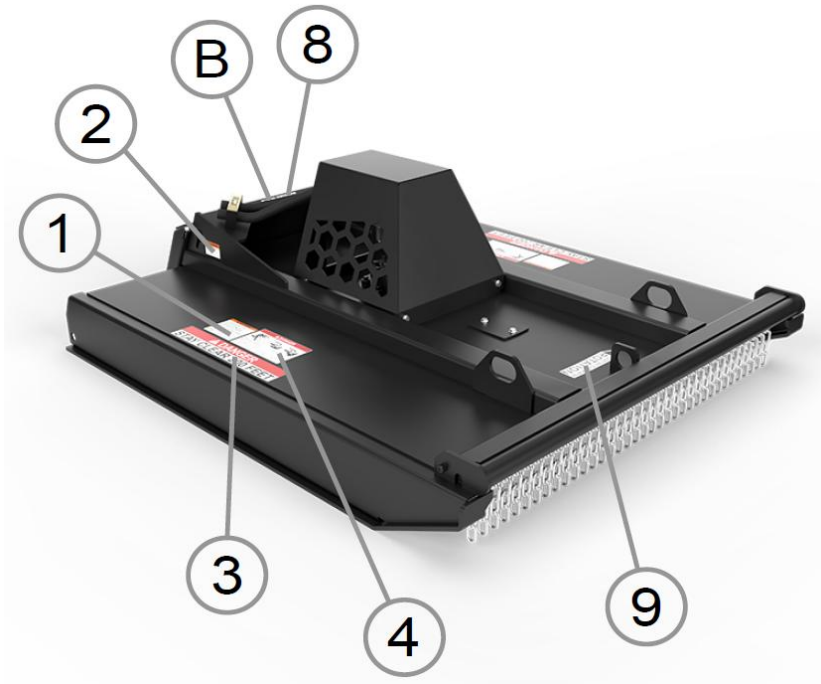

Hydraulic Component/Access Cover Assembly

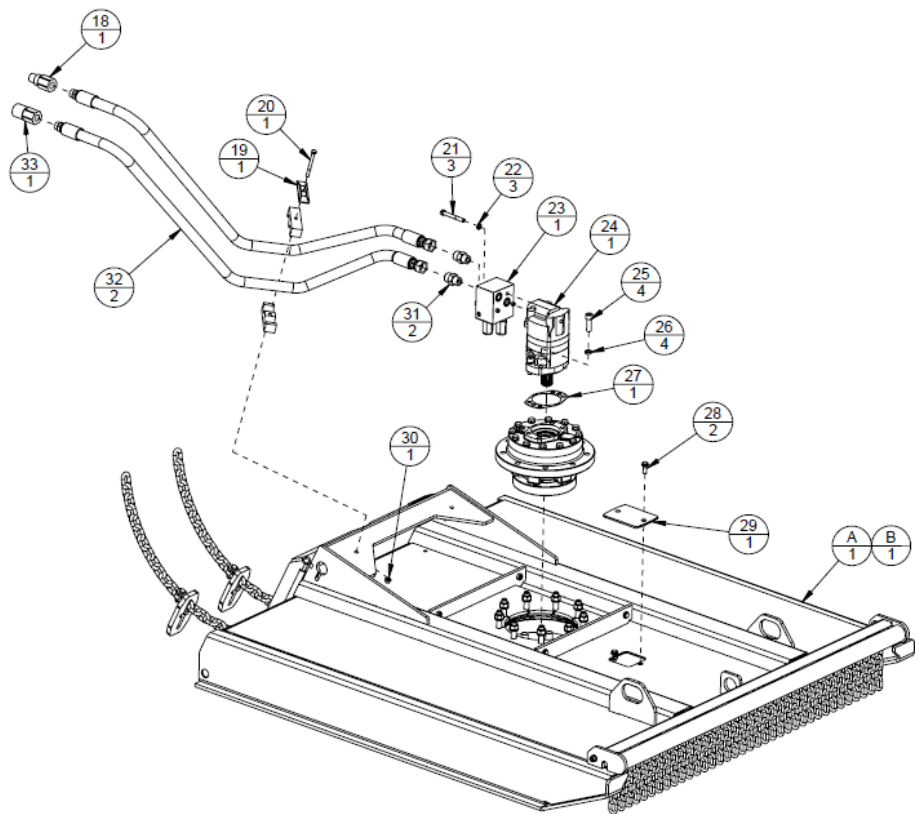
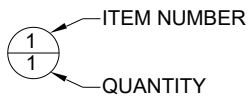

Hydraulic Component/Access Cover Assembly Parts List

CBC42			
ITEM	PART NO.	QTY	DESCRIPTION
A 10	13090VW	1	CBC42 DECK WDT
B 14	13600VW	1	CBC42 BOBTACH DECK WDT

*This table is model specific.

CBC42-O			
ITEM	PART NO.	QTY	DESCRIPTION
A 11	13061VW	1	CBC42-O DECK WDT
B 15	13602VW	1	CBC42-O BOBTACH DECK WDT

*This table is model specific.

CBC48			
ITEM	PART NO.	QTY	DESCRIPTION
A 12	13117VW	1	CBC48 DECK WDT
B 16	13593VW	1	CBC48 BOBTACH DECK WDT

*This table is model specific.

CBC48-O			
ITEM	PART NO.	QTY	DESCRIPTION
A 13	13105VW	1	CBC48-O DECK WDT
B 17	13598VW	1	CBC48-O BOBTACH DECK WDT

*This table is model specific.

Hydraulic Component/Access Cover Assembly Parts List (cont.)

ITEM	PART NO.	QTY	DESCRIPTION
18	6735PP	1	COUPLER MALE 12FB
19	8697PP	1	HOSE CLAMP ASSEMBLY 3/4" HOSE
20	10684PP	1	5/16"-18 X 3 1/4" LG HHCS
21	10127PP	3	3/8"-16 X 3" LG HHCS GR8
22	1075PP	3	3/8" LOCK WASHER
23	13588PP	1	CUL MANIFOLD DUAL CROSSOVER
24	12518PP	1	MOTOR CUTTER 4.0 MAGNETO MNT
25	6719PP	4	1/2"-13 X 1 1/2" LG SHCS
26	6720PP	4	1/2" HI-COLLAR LOCK WASHER
27	10320PP	1	MAGNETO MOUNT GASKET
28	13378PP	2	3/8"-16 X 1" LG HHSFS GR8
29	12641VP	1	BC-MX BOLT ACCESS COVER
30	7672PP	1	5/16"-18 TOP LOCK FLANGE NUT
31	9028PP	2	ADAPTER 12MJ TO 10MB
32	8276PP	2	HYD HOSE 3/4" X 78" LG 12MB TO 12FJX W/SLEEVE
33	6734PP	1	COUPLER FEMALE 12FB

Drive and Blade Assembly

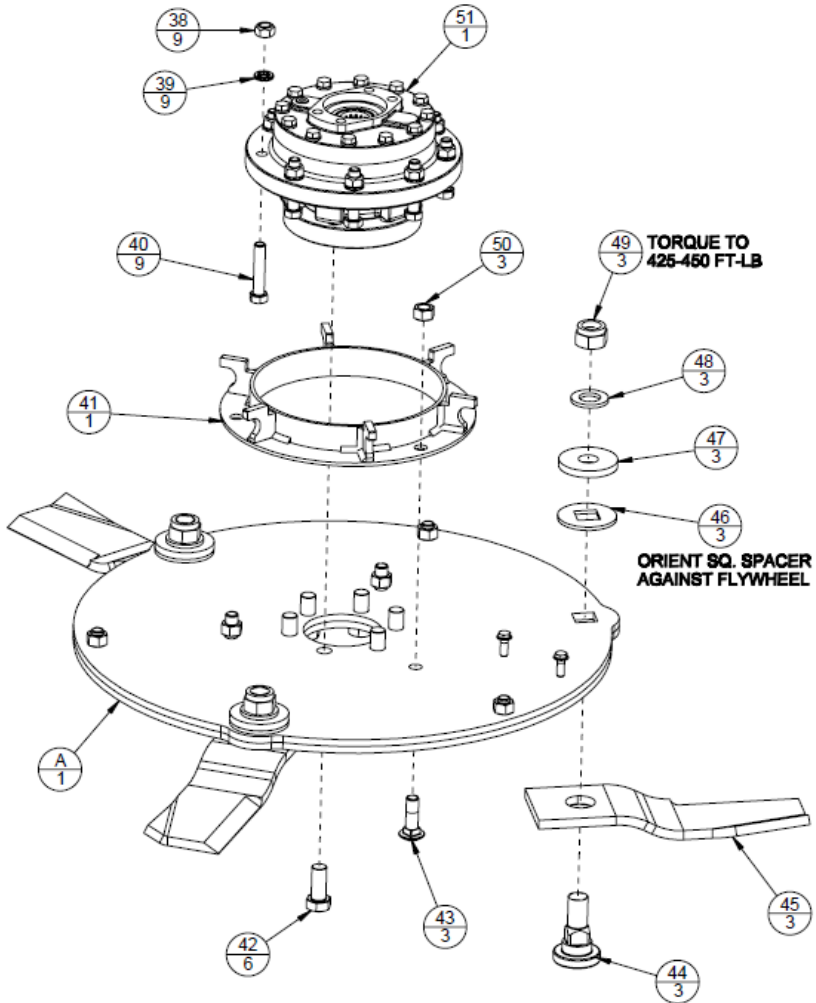
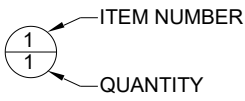

Note: Apply Loctite to Item #42 prior to assembly.

Drive and Blade Assembly Parts List

CBC42			
ITEM	PART NO.	QTY	DESCRIPTION
A 34	13062VA	1	FLYWHEEL ASSEMBLY

*This table is model specific.

CBC42-O			
ITEM	PART NO.	QTY	DESCRIPTION
A 35	13062VA	1	FLYWHEEL ASSEMBLY

*This table is model specific.

CBC48			
ITEM	PART NO.	QTY	DESCRIPTION
A 36	13106VA	1	FLYWHEEL ASSEMBLY

*This table is model specific.

CBC48-O			
ITEM	PART NO.	QTY	DESCRIPTION
A 37	13106VA	1	FLYWHEEL ASSEMBLY

*This table is model specific.

Drive and Blade Assembly Parts List (cont.)

ITEM	PART NO.	QTY	DESCRIPTION	
38	9717PP	9	9/16"-12 TOP LOCK NUT	
39	6717PP	9	9/16" HI-ALLOY LOCK WASHER	
40	7665PP	9	9/16"-12 X 2 3/4" LG HHCS GR8	
41	10125VW	1	SPINDLE GUARD WDT	
42	10090PP	6	3/4"-16 X 1 3/4" LG HHCS GR 8	
43	7790PP	3	5/8"-11 X 2" LG CB	
B	44	12693PP	3	BRUSH CUTTER BLADE BOLT 3"
B	45	-	3	BLADE CUL UPDRAFT
	46	13610VP	3	CUTTER SQ BOLT SPACER
	47	10110VP	3	PLATE SPACER
B	48	9340PP	3	1" DIAMETER NORD-LOCK WASHER
B	49	7330PP	3	1" -14 TOP LOCK
	50	1008PP	3	5/8"-11 TOP LOCK NUT
	51	10073PP	1	BEARING ADAPTER

B – MBK42 – Replacement blade kit for CBC42 and CBC42-O models includes 3 of each blade, bolt, spacer and nut.

B – MBK48 – Replacement blade kit for CBC48 and CBC48-O models includes 3 of each blade, bolt, spacer and nut.

Lift Limit Chain Assembly

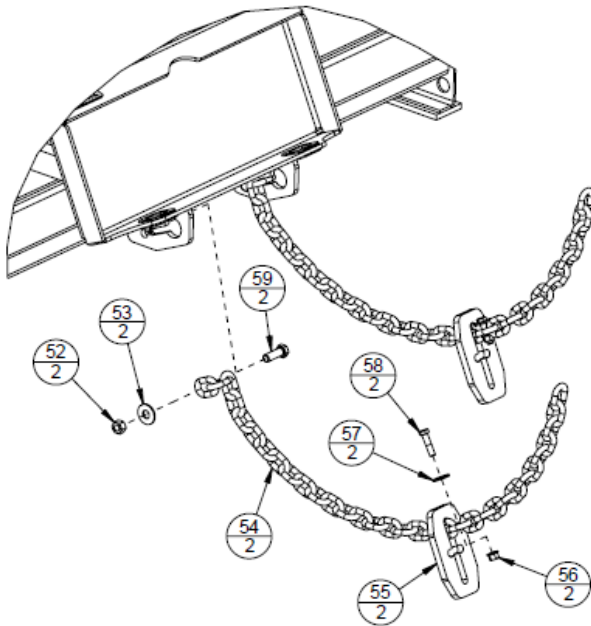
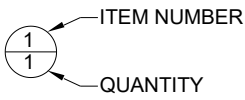

ITEM	PART NO.	QTY	DESCRIPTION
52	1003PP	2	1/2"-13 REVERSE LOCK NUT
53	5148PP	2	1/2" USS FLAT WASHER
54	7328PP	2	3/8" X 42" GR80 LIFT LIMIT CHAIN
55	7479VP	2	LIFT LIMIT RETAINER PLATE
56	6140PP	2	3/8"-16 TOP LOCK FLANGE NUT
57	1083PP	2	3/8" USS FLAT WASHER
58	7335PP	2	3/8"-16 X 1 1/2" LG HHCS
59	5226PP	2	1/2"-13 X 1 1/2" LG HHCS

Flywheel Assembly

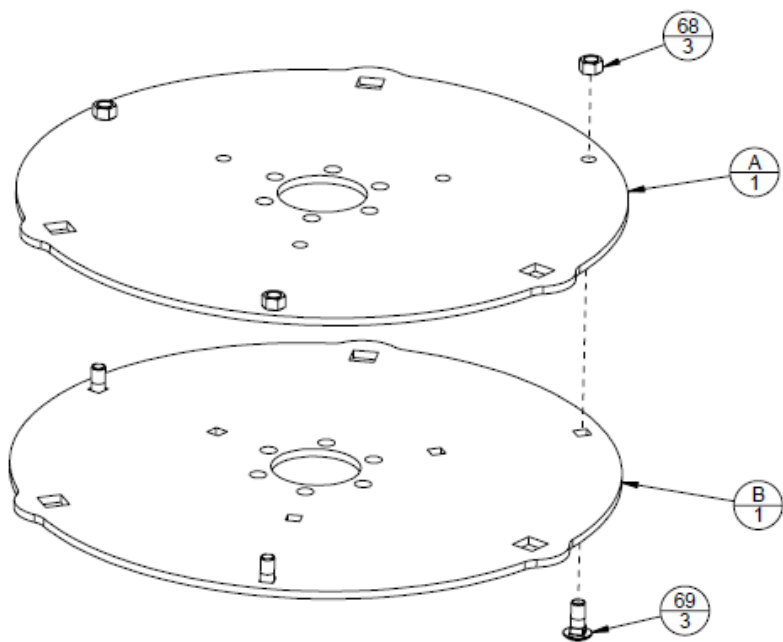
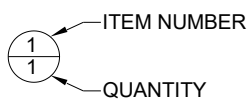

Flywheel Assembly Parts List

CBC42				
ITEM	PART NO.	QTY	DESCRIPTION	
A	60	13064VP	1	CBC42 FLYWHEEL TOP PLATE
B	64	13063VP	1	CBC42 FLYWHEEL BOT PLATE

*This table is model specific.

CBC42-O				
ITEM	PART NO.	QTY	DESCRIPTION	
A	61	13064VP	1	CBC42 FLYWHEEL TOP PLATE
B	65	13063VP	1	CBC42 FLYWHEEL BOT PLATE

*This table is model specific.

CBC48				
ITEM	PART NO.	QTY	DESCRIPTION	
A	62	13108VP	1	CBC48 FLYWHEEL TOP PLATE
B	66	13107VP	1	CBC48 FLYWHEEL BOT PLATE

*This table is model specific.

CBC48-O				
ITEM	PART NO.	QTY	DESCRIPTION	
A	63	13108VP	1	CBC48 FLYWHEEL TOP PLATE
B	67	13107VP	1	CBC48 FLYWHEEL BOT PLATE

*This table is model specific.

ITEM	PART NO.	QTY	DESCRIPTION	
	68	1008PP	3	5/8"-11 TOP LOCK NUT
	69	6773PP	3	5/8"-11 X 1 1/2" LG CB

Motor Guard Assembly

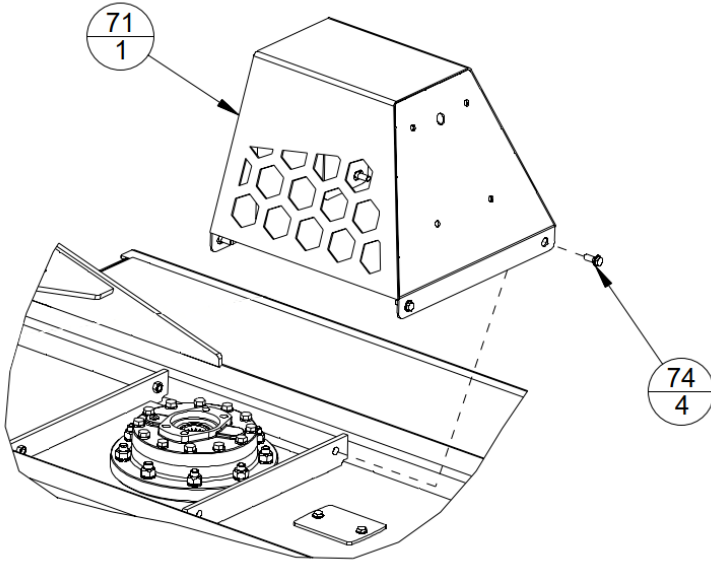
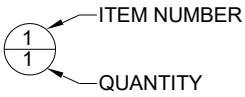

ITEM	PART NO.	QTY	DESCRIPTION
71	12842VW	1	CUTTER GUARD WELDMNT STD
74	13378PP	4	3/8"-16 X 1" LG HHSFS GR8

Chain Curtain Assembly

(This applies to CBC models only)

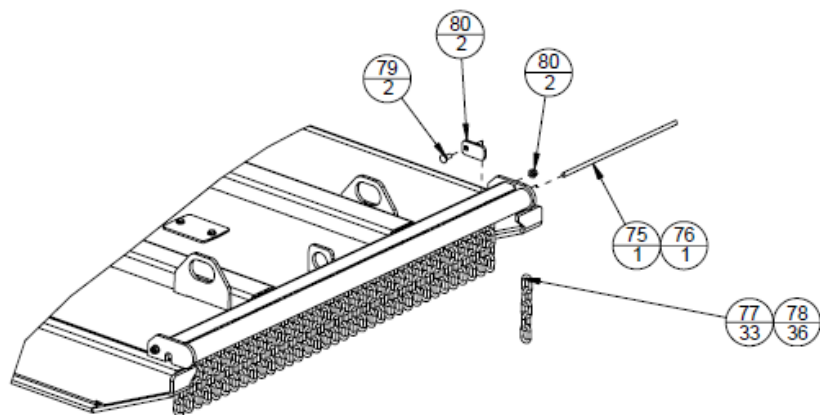
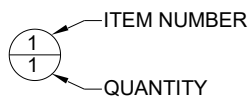

Chain Curtain Assembly Parts List

(This applies to CBC models only)

CBC42			
ITEM	PART NO.	QTY	DESCRIPTION
75	13103VP	1	CHAIN ROD
77	7327PP	33	5/16" X 5 LINK CHAIN GRADE 30

*This table is model specific.

CBC48			
ITEM	PART NO.	QTY	DESCRIPTION
76	13127VP	1	CHAIN ROD
78	7327PP	36	5/16" X 5 LINK CHAIN GRADE 30

*This table is model specific.

ITEM	PART NO.	QTY	DESCRIPTION
79	1089PP	2	3/8"-16 X 1" LG CARRIAGE BOLT
80	13092VP	2	CBC CHAIN ROD KEEPER PLATE
81	6140PP	2	3/8"-16 TOP LOCK FLANGE NUT

